

Description

Based on strain gauge technology, UPC7 pressure transducer uses strain gauges as sensing elements. The strain gauges form a Wheatstone bridge on back of the diaphragm to sensing the deformation of the diaphragm, this deformation results from the pressure which act vertically to the diaphragm. As the sizes of strain gauges are very small and can be designed so many different types to suit different situations, therefore the application of UPC7 strain gauge pressure transmitter is very wide these days.

UPC7 strain gauge pressure transducer is mainly used for static or dynamic pressure measurement of flowing medium, for example power conduit equipment's input or output gas or liquid pressure, internal combustion engine pipeline pressure and so on.

Features

- High measuring accuracy
- Suitable for middle and high pressure measurement
- Anti-corrosive, anti-impact
- Pressure port is cavity or flush diaphragm

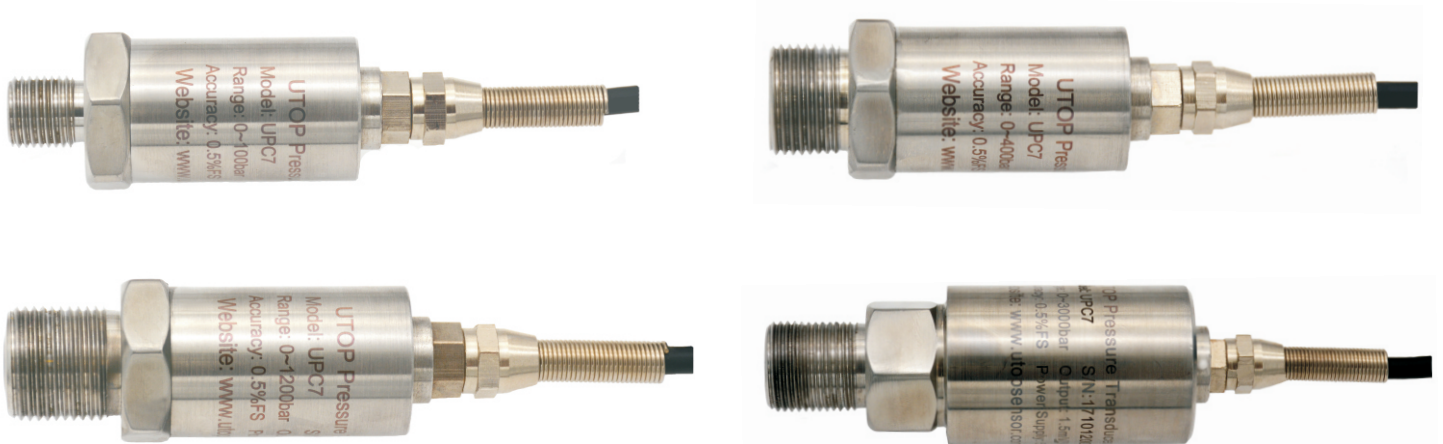

Specifications

pressure medium	gas or liquid compatible to stainless steel
pressure ranges	0~10bar...6000bar
overload pressure	150%FS
output signal	1.5mV/V(stansard),2mV/V
accuracy	0.25%FS, 0.5%FS(standard)
zero unbalance	<±2%FS
long-term stability	<0.2%FS/year
suggested supply voltage	5VDC~12VDC
max. supply voltage	18VDC
compensated temperature range	-10~+60°C
operating temperature range	-20~+100°C



UPC7 Strain Gauge Pressure Transducer

temperature coefficient of zero	0.2%FS/10°C
temperature coefficient of span	0.2%FS/10°C
input resistance	380±5Ω, 1000±5Ω
output resistance	350±5Ω, 1000±5Ω
insulation resistance	100MΩ@50VDC
process connection	G1/4 or others
electrical connection	3m PVC cables
material of wetted part	17-4PH
material of housing	1Cr18Ni9Ti

Electrical connection

connection	cable color
excitation“+”	red
excitation“-”	black
signal“+”	green
signal“-”	white

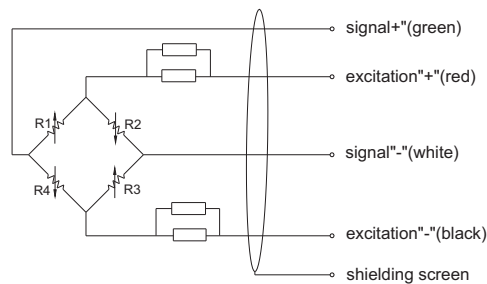

Note: please refer to the user manual for the actual wiring

Dimensions

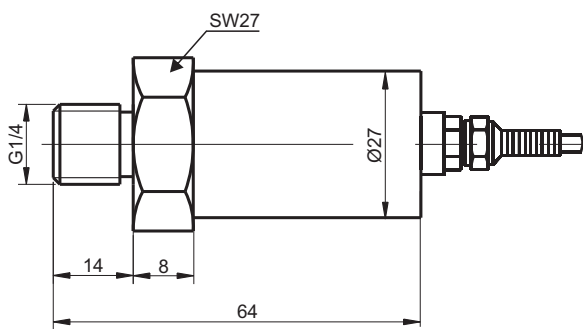

range:40~400bar

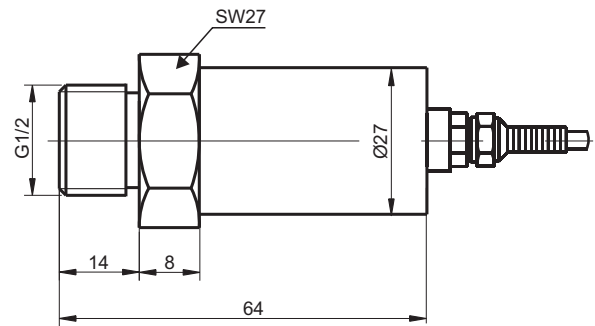

range:400~700bar

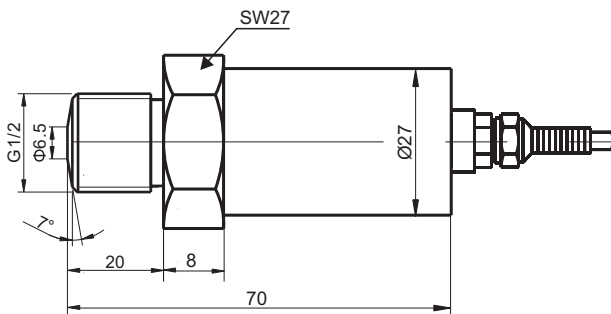

range:800~2500bar

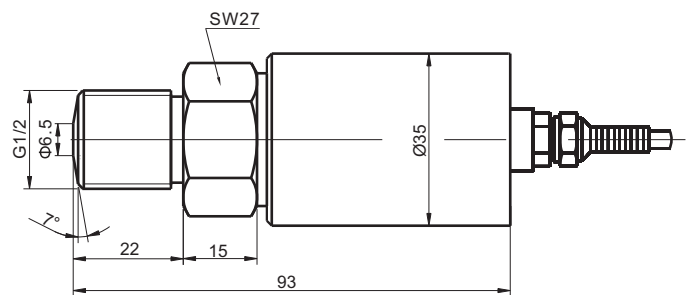

range:3000~6000bar



UPC7 Strain Gauge Pressure Transducer

Ordering code

UPC7						
	range	measuring range: 0~10bar...6000bar				
	(0~X)bar	X: actual measuring range				
		code	output			
		O2	1.5mV/V			
		O3	2mV/V			
			code	accuracy		
			C	0.25%FS		
			D	0.5%FS		
				code	process connection	
				P1	G1/4	
				P2	G1/2	
				P4	M20x1.5	
				Pz	customer request	
					code	electrical connection
				E1	hirschmann connector	
				E2	aviation connector	
				E3	cable(lock nut)	
				Ez	customer request	
UPC7	(0~200)bar	O1	D	P1	E2	